

EPSON®
EXCEED YOUR VISION



Epson G Series



When image is everything,
real value stands out



Projectors that stand out

Epson G Series projectors are powerful, bright and can be ceiling-mounted to reach large audiences. A unique mix of innovative features and smart design simplifies installation, operation and monitoring to dramatically enhance the visual experience of your audience. Built to strict environmental standards, they are cost efficient and provide exceptional long-term value.

These projectors are ideal for very large corporate meetings or shareholder gatherings; for theatres and halls in educational or cultural institutions; for digital signage in airports or shops; for special big events such as lectures, civic celebrations or sports tournaments.



Trust the world leader
for the last 7 years
to deliver your message
in lecture theatres or classrooms.

Source: Decision Tree Consulting Ltd.



Bright natural images



With single panel system*

With Epson 3LCD technology

The Epson G Series projectors produce bright clear images with great colour fidelity on screens up to 300 inches (diagonal). Images look superb in ambient lighting, even daylight, which allows a lot of flexibility when arranging a venue.

This high quality is thanks to two proprietary technologies. Epson 3LCD provides natural colour reproduction, and the Epson compensation filter achieves a very high native contrast ratio (up to 1000 :1).

* Images for illustrative purposes only.

LAN



Manage your networked projectors

From one PC running Epson Network monitoring and control software you can see at a glance which projectors are available and if they are running efficiently – no matter how wide your network is.

You can configure Epson projectors remotely, as well as receive instant alerts on pre-defined critical indicators such as non-functioning devices or overheating lamps.

Users have instant access to the settings of their individual projector and to online IT support. Controlling settings or putting projectors onto a common timer allows efficient running, which reduces energy costs.

EasyMP™ Easy Multimedia Presentation technology *

Standalone operation makes life simple

As your projector can be ceiling-mounted and perhaps out of reach, the Epson EB-G5350 allow you to store your presentations, movies, or pictures in the projector on an SD card. You simply launch the presentation whenever you want by using the remote control. And if you wish to edit your file – or someone else needs to set up their slideshow - this is easily done. Just upload the new file over the network from a PC to the SD card. It's fast, flexible and totally secure.

When the projector is sitting on a table and easily accessible, you don't even need a PC. Simply put your file onto a USB key and plug it into the projector. What could be simpler?

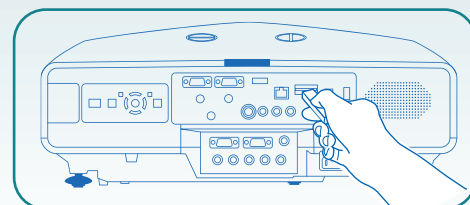

Simply plug in your USB key or SD card

Less wires, more freedom **

Epson EasyMP projectors can connect to computers via wired or wireless LAN. Connecting wirelessly saves the trouble and awkwardness of cables. Wireless connection is stable, and delivers the fast transfer speeds needed for full movies with sound.

Security is guaranteed through strong encryption technologies (compatible with Cisco CCXv4 protocols). Of course you can still use normal RGB cabling or simply connect your projector and PC by using Epson USB display function.



Make a great show with more screens

You can link your PC to up to four separate projectors, by wireless or wired LAN, and project onto all screens.

Spread your visual across several displays, in panorama or a large square - invaluable for looking at complex spreadsheets and wide pictures. You can also show up to four different visuals - each running on a different application - and move between them.



Certified for Windows Vista™* Network Projector function

The Epson EB-G5350 Windows Vista™ work together with no need to install additional applications or drivers. Simply connect the projectors to a PC with Windows Vista™ and launch the network projector function (WLAN or LAN). *Excluding «Home Basic Edition»

* EasyMP functions are only available on the Epson EB-G5350.

** Wireless adapter required (option code: V12H306P11)

Easy to install, simple to adjust

Epson understands that a user's priority is to concentrate on their presentation and their audience. A projector should be straightforward to install, configure and maintain. The Epson G Series projectors were designed with all this in mind.

Intelligent installation

Although bright and powerful, the Epson G Series are incredibly compact and weigh less than 7Kg, which makes all the difference when mounting them on a ceiling.

From the front, one feature really stands out. The lens unit is centred, so aligning the projector is simple.



Cable cover for neat installation (included)



Security bar and Kensington lock hole



Easy, safe lens attachment

The modular lenses are bayonet-mounted in a single movement. They are quick to change yet once in place can be totally secured by an anti-theft screw.

Lens shift

This allows horizontal/vertical manual adjustment of images on the screen with no loss of quality. 60% vertical/10% horizontal lens shift on WXGA model, 50% vertical/10% horizontal on XGA models.

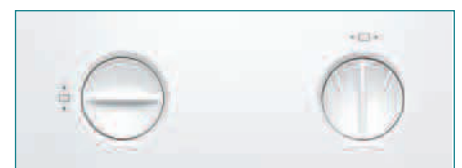
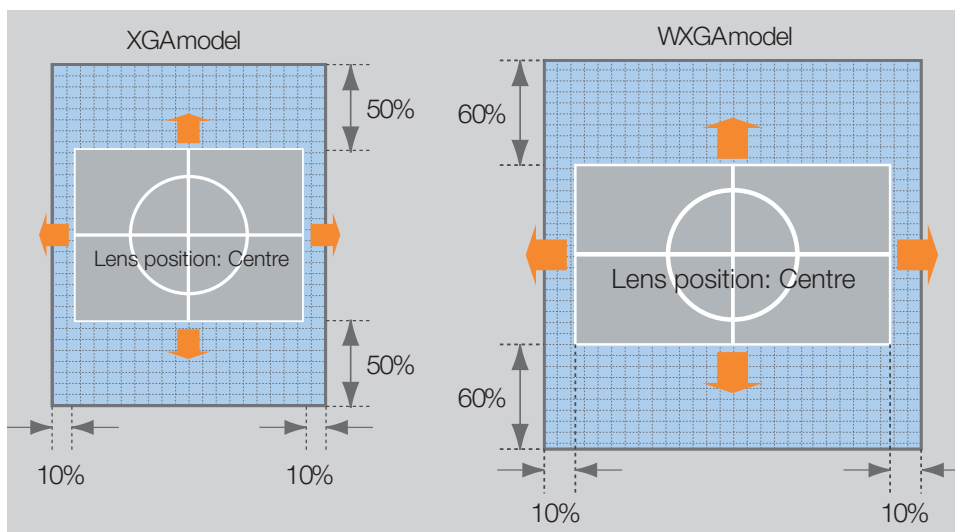

Horizontal and vertical lens shift dials on top of the projector

Keystone correction

Achieve a squared image instantly and easily by adjusting distortions up to +/-40 degrees vertically and +/-20 degrees horizontally.

Focus on flexibility: modular lenses

With the Epson G Series you can always choose the perfect projector because there are five different lenses available. This ensures you invest in a solution that suits your pocket – as well as suiting the conditions of particular venues and different types of multimedia content. The optional lenses allow you to mix zoom and wide-angle functions to suit your needs.

You can display a 100inch image with a projection range from 1.58 to 14.57 metres in XGA, and 1.66m to 15.33m in WXGA.

Projection distances in XGA and WXGA

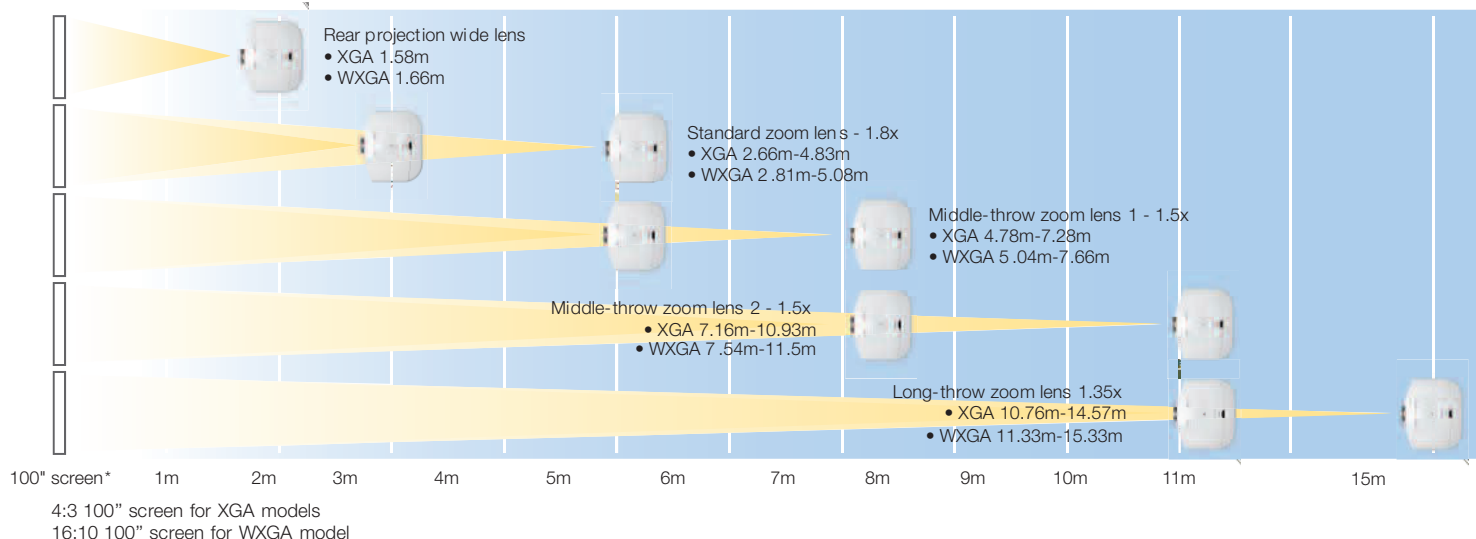

Choice of lenses

Lens type		Standard Zoom Lens	Rear Projection Wide Lens	Middle-Throw Zoom Lens 1	Middle-Throw Zoom Lens 2	Long-Throw Zoom Lens
Reference		ELPLS03	ELPLR03	ELPLM04	ELPLM05	ELPLL06
Option lens						
Focus/Zoom type		Manual	Manual (No zoom)	Manual	Manual	Manual
Zoom ratio		1 - 1.8	-	1 - 1.5	1 - 1.5	1 - 1.35
Throw ratio* for XGA models 4:3 and 16:9 aspect ratios		1.3-2.4	0.78	2.4-3.6	3.5-5.4	5.3-7.2
Throw ratio* for WXGA model	16:10 and 16:9 aspect ratios	1.3-2.3	0.77	2.3-3.5	3.5-5.3	5.2-7.1
	4:3 aspect ratio	1.5-2.8	0.92	2.8-4.3	4.2-6.4	6.3-8.5
F Number		1.64-2.5	2.03	1.83-2.45	1.83-2.53	1.84-2.32
Focal Length		21.27mm -37.93mm	12.76mm	38.07mm -57.09mm	56.76mm -85.25mm	84.91mm -114.61mm
Screen size range		30-300 inch	30-200 inch	40-300 inch	40-300 inch	40-300 inch
Manual Lens shift	Vertical (XGA model)	±50% max	-	±50% max	±50% max	±50% max
	Vertical (WXGA model)	±60% max	-	±60% max	±60% max	±60% max
	Horizontal	±10% max	-	±10% max	±10% max	±10% max
Anti-Theft screw		Included	Included	Included	Included	Included
Lens protection		Lens cover cap	Lens cover cap	Lens cover cap	Lens cover cap	Lens cover cap
Weight		0.6 Kg	0.78 Kg	0.89 Kg	0.95 Kg	0.9 Kg
Order number		V12H004S03	V12H004R03	V12H004M04	V12H004M05	V12H004L06

*Projection distance = Screen width x Throw ratio

To choose the right lens for your needs, visit www.epson.com.au and download the latest Projector Distance Calculator.

A wide range for maximum flexibility

The right projector for you

With five projectors in the Epson G Series you can be sure of finding one that will match your requirements. Designed for reliability, easy maintenance, and low running cost, the projectors come in two levels of brightness. Their sleek, compact design also allows them to fit unobtrusively in a boardroom or other venue. The integrated 7W speakers can fill a medium-sized room.

All models are XGA except the Epson EB-G5200W with its native widescreen panel. Epson Network Integration simplifies remote monitoring of the projectors and reduces their running costs. EasyMP allows your projector to run standalone from a portable drive, connect wirelessly to a PC and screen, and run simultaneously with up to four projectors.



Epson
EB G5350

5000 ANSI lm



XGA

EasyMP™



Epson
EB G5200W

4200 ANSI lm



WXGA

LAN

Epson
EB G5100

4000 ANSI lm



XGA

LAN



You're free to move

The new remote control has a very wide range and functions at a greater distance than before, thanks to two built-in infrared receptors. You can be far more mobile during your presentation. If the venue is unsuitable for IR reception you can also attach the remote control to the projector by a 20-metre cable (optional).

Easy maintenance

Higher reliability

The new long-lasting lamp can operate for up to 3,000 hours of normal use. The redesigned electrostatic filter is both highly efficient at keeping out dust and also very durable.

Easy to change

When finally the filter and lamp do need to be changed it can be done in a minute. They are easily accessible through a side hatch, which also minimises the risk of dropping the lamp accidentally.



Slide-in high efficiency filter



Safe access to lamp

Connections: all you need, yet simple

Look at the back and it is clear that the Epson G Series projectors are built to connect to a wealth of devices. They are compatible with the latest audiovisual and PC standards, including HDMI.

Connections are arranged on two levels, one inside for ceiling installation cables and another for desktop inputs. This keeps everything tidy and convenient for quick access.

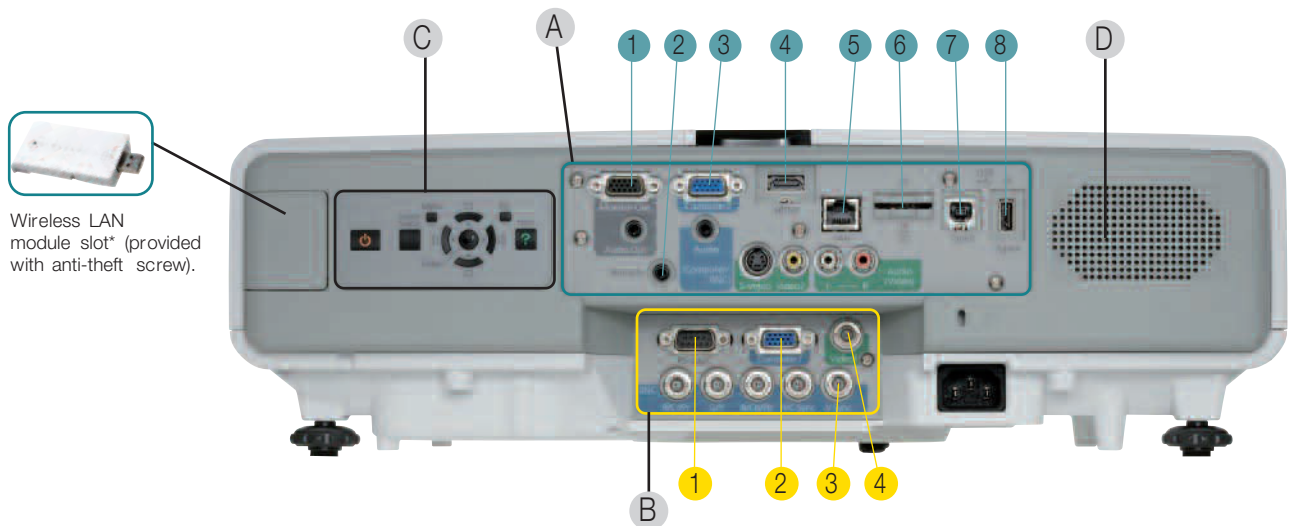

A - For desktop usage

- 1 - Monitor out
- 2 - Wired remote jack
- 3 - Computer 2 (D-sub 15)
- 4 - HDMI
- 5 - RJ45
- 6 - SD Card slot*
- 7 - USB Type B*
- 8 - USB Type A*

B - For ceiling-mount usage

- 1 - RS-232C
- 2 - Computer 1 (D-sub 15)
- 3 - 5 BNC
- 4 - Composite video (BNC type)

C - Rear-located control panel

D - Speaker (7W)

* Not available on EB-G5100 & EB-G200W

Easy cost efficient running, and impressively green

Epson G Series projectors are designed for the long-term, and that means low-cost efficient operation. They are manufactured according to Epson's strict Environmental Management System, which is based on ISO 14001.

The ability to monitor the projectors remotely ensures they are never left on by accident, and allows timely intervention if required.

Details that make the difference:

- Projector body contains no paint coatings (except immediately around the lens) to enable recycling.
- No use of lead in the lens, or of halogen fireproofing.
- Operates on relatively low power (327W), and extremely low consumption on stand-by (0.6W).
- Packaging is made with recycled materials.

Specifications Epson G series

Projection system (3LCD)	EB-G5100/EB-G5350 EB-G5200W	0.8-inch with MLA (x3) TFT 0.74-inch with MLA (x3) TFT
Native resolution	EB-G5100/EB-G5350 EB-G5200W	XGA (1024 x 768) / Native Aspect Ratio 4:3 WXGA (1280 x 800) / Native Aspect Ratio 16:10 Analog Signal: VGA – UXGA - Digital video standard: up to 720p/1080p
Resolution supported		Horizontal: 15 kHz to 99 kHz - Vertical: 50 Hz to 120 Hz
Frequency (analog)		
Brightness	EB-G5100 EB-G5200W EB-G5350	High/Low brightness mode: 4000 ANSI lm / 3200 ANSI lm High/Low brightness mode: 4200 ANSI lm / 3360 ANSI lm High/Low brightness mode: 5000 ANSI lm / 4000 ANSI lm
Projection lens		5 optional lenses: See specifications p.5
Lamp <ul style="list-style-type: none"> Type Life 	EB-G5100 EB-G5350/EB-G5200W	210 W UHE 275 W UHE 3000 hours / 2000 hours (Low/High brightness mode) (ESTIMATED)
Colour Reproduction		Full-Colour (16.77 million colours)
Picture Quality improvements		3D Y/C separation, Noise Reduction Motion compensated Interlace-P progressive conversion
Fan noise	EB-G5100 EB-G5200W EB-G5350	Low/High brightness mode: 29 dB / 35 dB Low/High brightness mode: 30 dB / 37 dB Low/High brightness mode: 31 dB / 38 dB
Contrast ratio	EB-G5100/EB-G5350 EB-G5200W	1000:1 800:1
Keystone correction		Vertical: ±40 degrees Horizontal: ±20 degrees
Input <ul style="list-style-type: none"> Computer Video Digital (Video & Audio) Audio Control PC Free USB Display 	EB-G5350 only EB-G5350 only	2xD-sub 15-pin (RGB), 1x5-BNC 2xD-sub 15-pin (component), 1xRCA, 1xS-Video, 1x1-BNC 1xHDMI (up to 720p/1080p) 1xStereo mini-jack, 2xRCA (White/Red) 1xRS-232C 1xUSB type A, 1xSD Card slot (SDHC compatible) 1xUSB type B
Output		Computer / Audio: 1xD-sub 15-pin / 1xStereo mini-jack
Network input		1xRJ45 (LAN)
Network Monitoring functions		Projector control and projector management via network (wireless or wired LAN) : - Monitor Power status, Lamp status, Lamp hours, Temperature level, Error information, IP address - Control Epson projectors (Power On/Off, Change input sources), E-mail notification, Timer function Other features: SNMP, Web control, PJ-Link, Projector Control
Epson Network Software		EMP Monitor (for Windows) Epson Projector Control Software (for Windows, Web download only)
Built-in speaker		7W monaural
Direct Power On/Off		Yes
Security		Security bar, Kensington lock hole, lens lock screw
Other functions		Quick Corner, Source Search, Auto Detection of RGB/Component, Password Protected Function, 9 Colour Modes, High Altitude Mode, User logo, Freeze, A/V Mute slide, E-Zoom, Help, Test Pattern, Fan Stops at Network Standby, Remote Projector ID Function, Multi Screen colour adjustment function, AMX Device Discovery
Power supply wattage		100 - 240 V AC ±10%, 50/60 Hz
Power consumption lamp on	EB-G5350/EB-G5200W EB-G5100	398W 327W
Power consumption stand-by		0.6W (network off) / 12W (network on)
Operating temperature / altitude		0°C to 40°C / 0 to 3,000m (High Altitude Mode over 1500m)
Weight	EB-G5100 EB-G5200W EB-G5350	6.6 kg 6.7 kg 6.8 kg
Dimension (D x W x H)		381x 470x 135mm (excluding feet and lens)
On-screen menu		27 languages English, French, German,Italian,Spanish, Catalan, Portuguese, Russian,Ukrainian, Dutch, Danish, Hungarian, Czech, Polish, Romanian, Slovenian, Norwegian, Finnish, Swedish, Greek, Turkish, Arabic, Japanese, Chinese, Traditional Chinese, Korean, Thai
Warranty		2 years*



Accessories

Power Cable	3m (included)
Computer Cable	1.8 m (included)
Remote Control 2xAA type batterie s	included
User Manual	included
Epson Projector Software (CD-ROM)	included
Password Protect Sticker	included
Control Panel and Interface Stickers	included
Cable Cover	included
Lens release button lock screw	included with lens
Standard lens (ELPLS03)	included
Optional lenses	See spec. p.5
Spare Lamp 275W for EB-G5350 EB-G5200W	V13H010L46
Spare Lamp 210W for EB-G5100	V13H010L47
Spare High Efficiency Filter	V13H134A17
Wireless LAN adapter (ELPAP03) for EB-G5350	V12H306P11

Advanced Functions	EPSON EB-G5350
Certified for Windows Vista™ Network Projector function	Wired or wireless connection between projector and computer with Windows Vista™ operating system (excluding Home Basic edition)
EasyMP™ Functions	
Wired/Wireless connection <ul style="list-style-type: none"> Wireless connection Advanced Functions Supported Security Protocols 	Wireless LAN (802.11a/b/g) Multi-screen display (up to four projectors) with Windows 2000 and XP, Movie sending (MPEG2, WMV), WPS WEP: 128bit/64bit - WPA-PSK: TKIP/AES - WPA2-PSK: TKIP/AES - EAP(WiFi/WPA): EAP-TLS, EAP-TTLS/MD5, EAP-TTLS/MS-CHAPv2, PEAP/MS-CHAPv2, PEAP/GTC - EAP(Cisco): CCXv4, LEAP, EAP-Fast/MS-CHAPv2, EAP-Fast/GTC
<ul style="list-style-type: none"> Supported Operating systems USB Display 	Windows 2000/ XP/Vista - Mac OS X 10.3/10.3.9/10.4.5/10.5.1 1xUSB type B for computer input
PC free function <ul style="list-style-type: none"> Input Supported formats Advanced Functions 	1xUSB type A, 1xSD Card Slot (SDHC compatible) IMAGE: JPEG/BMP/GIF/PNG - MOVIE: MPEG2/MPEG4 ASP/MPEG4 AVC(H.264)/WMV8,9 - PRESENTATION SCENARIO: SIT (created by EMP Slidemaker2) Transferring or writing files to SD Card from network (SMB)
EasyMP™ Software	EMP NS Connection (for Windows and Mac), EMP Slidemaker2 (for Windows)

* Excluding Lamp



For further information please contact your local Epson office or visit www.epson.com.au or www.epson.co.nz

Australia 3 Talavera Road, North Ryde, NSW 2113, Australia (02) 8999 3666
New Zealand Level 4, 245 Hobson Street, Auckland, New Zealand 0800 23 77 66

Epson® is a registered trademark of Seiko Epson® Corporation. All other product names and other company names used herein are for identification purposes only and may be trademarks or registered trademarks of their respective owners. Errors and omissions excepted, all specifications are subject to change without notice.

EPSON
EXCEED YOUR VISION